



Job Name _____

Location _____

Engineer _____

Wholesaler _____

Contractor _____

Model No. _____

Date _____



SPECIFICATION

SFC 199

CSA Input (Natural Gas or Propane) – MBH	28.3 - 125
CSA Input (Natural Gas or Propane) – KW	8.29 - 36.6
CSA Output – MBH	27.1 - 111
CSA Output - KW	7.94 - 32.5
DHW - CSA Input (Natural Gas or Propane) - MBH	28.3 - 199
DHW - CSA Input (Natural Gas or Propane) - KW	8.29 - 58.3
A.F.U.E	95%
Min Gas Pressure (Nat. Gas or Propane) – inch w.c.	4
Max Gas Pressure (Nat. Gas or Propane) – inch w.c.	14
Power (120Vac/60Hz) - Watts @ full fire with internal pump	120
Weight (empty) – lbs/Kg	84 / 38
Pressure Vessel water content – USG/Liters	0.19/.72
Max boiler flow rate - USgpm	12
Min boiler flow rate - USgpm	2
Max Operating Pressure – Space Heating Coil - psig †	43.5
Max Operating Pressure – Domestic Hot Water Coil - psig	150
Minimum water pressure - psig	8
Approved installation altitude - ASL	10,000 ft
Ambient Temperature – Low (°F/°C)	32/0
Ambient Temperature – High (°F/°C)	122/50
Max relative humidity (non-condensing)	90%
Min water Temperature - Space Heating (°F/°C)	50/10
Max water Temperature – Space Heating (°F/°C)	194/90
Min water Temperature – Domestic Hot Water (°F/°C)	104/40
Max water Temperature – Domestic Hot Water (°F/°C)	149/65
Min flow rate to activate DHW heating - USgpm	0.5
Max flow rate DHW heating - USgpm	7
Domestic Hot Water Delivery: @70°F temperature rise - USgpm	5.0

* Units ship configured for Natural Gas (NG) with a Propane (LP) conversion kit included. Converting an LP unit back to NG requires the certified NG conversion kit that can be ordered separately.

† units are shipped with 30 psig pressure relief valve

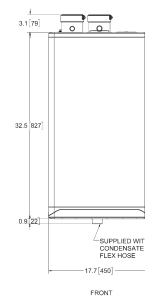

Front

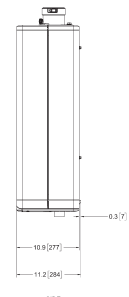

Side

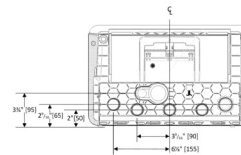

Bottom

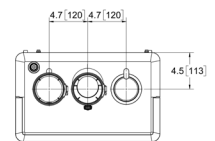

Top

Cabinet Clearance

Surface	Distance from Combustible Surfaces	Recommended Distance for Installation and Service
Front	2"	24"
Rear	0"	0"
Left Side	1.5"	6" (labels may be difficult to read with reduced clearance)
Right Side	4"	6" (labels may be difficult to read with reduced clearance)
Top	2"	24"
Bottom	8"	24"

Maximum Exhaust Venting Lengths

Exhaust Pipe Size/Fittings	Maximum Equivalent Length
Schedule 40 PVC, CPVC or PPs – Allowances are for each side separately.	
2"	35'
3"	120'
2" or 3" 90' Long Sweep Vent Elbow	Allow 5 equivalent feet
2" or 3" 90' Short Sweep Vent Elbow	Allow 8 equivalent feet
2" or 3" 45' Vent Elbow	Allow 3 equivalent feet
PPS	
PPs 87-90' Elbow	Allow 8 equivalent feet
Flex PPS – Factor = 1.4	
3" PPs Flex	Max. 35 linear feet Actual linear feet times 1.4