

HIBISCUS

SIMPLE SELECT DUAL SHOWER HEAD SHOWER SYSTEM

SKU: 949740



CONTENTS

TRIM	PAGE 2
ROUGH-IN VALVE	PAGE 3
SHOWER HEAD	PAGE 4
SHOWER ARM	PAGE 5

FEATURES

- Shape: Square
 - Handle Type: Lever
 - Features: Pressure-Balanced
 - Assembly Required: Yes
 - Design: Modern
 - Mounting Hardware Included: Yes
 - Shower Head Installation Type: Ceiling
 - Number of Shower Heads: 2
 - Shower Head Material: Stainless Steel
 - Shower Head Spray: Rainfall
 - Shower Arm Included: Yes
 - Shower Head Swivel: Yes
 - Diverter Included: Yes
 - Diverter Outlets: 2
 - Dual Functionality Allows for One or Both Shower Features to Run at a Time
 - Single Function Shower Heads (Full Spray)
 - Easy-Clean Silicone Nozzles
- Optional Rough-In Valve:**
- Pressure Balanced With Integral Stops
 - One-Piece Cartridge Design For Ease of Maintenance
 - Back-to-Back Capability
 - Adjustable Temperature Limit Stop
 - Quick Remove Plaster Guard
 - Easy Mounting Brackets
 - With Restrictor Installed, This Valve is Compliant With CALGreen and the California Plumbing Code

REVISED 03/18/2021

HIBISCUS

SIMPLE SELECT TRIM

SKU: 949740

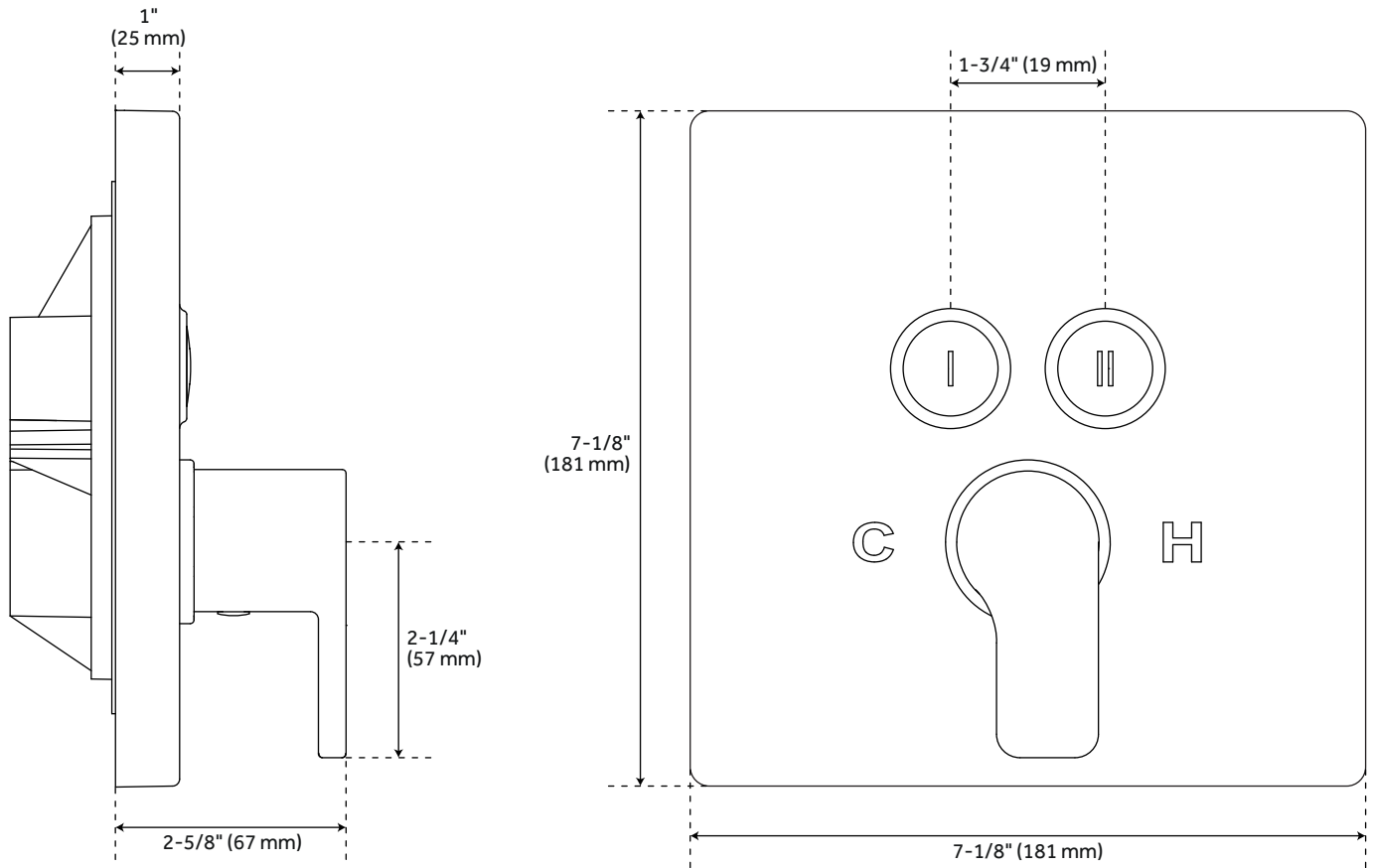

FEATURES

Material: Brass
Width: 7-1/8"
Height: 7-1/8"
Depth: 2-5/8"
Connection: 1/2" NPT

CODES/STANDARDS

cUPC
ASME A112.18.1/CSA B125.1
ICC/ANSI A117.1 (when installed
according to ADA standards)
Massachusetts Accepted

PRODUCT IMAGE



All dimensions and specifications are nominal and may vary. Use actual products for accuracy in critical situations.

PAGE 2
Code: SHHB8040Z

HIBISCUS

OPTIONAL PRESSURE BALANCE ROUGH-IN VALVE

SKU: 949740

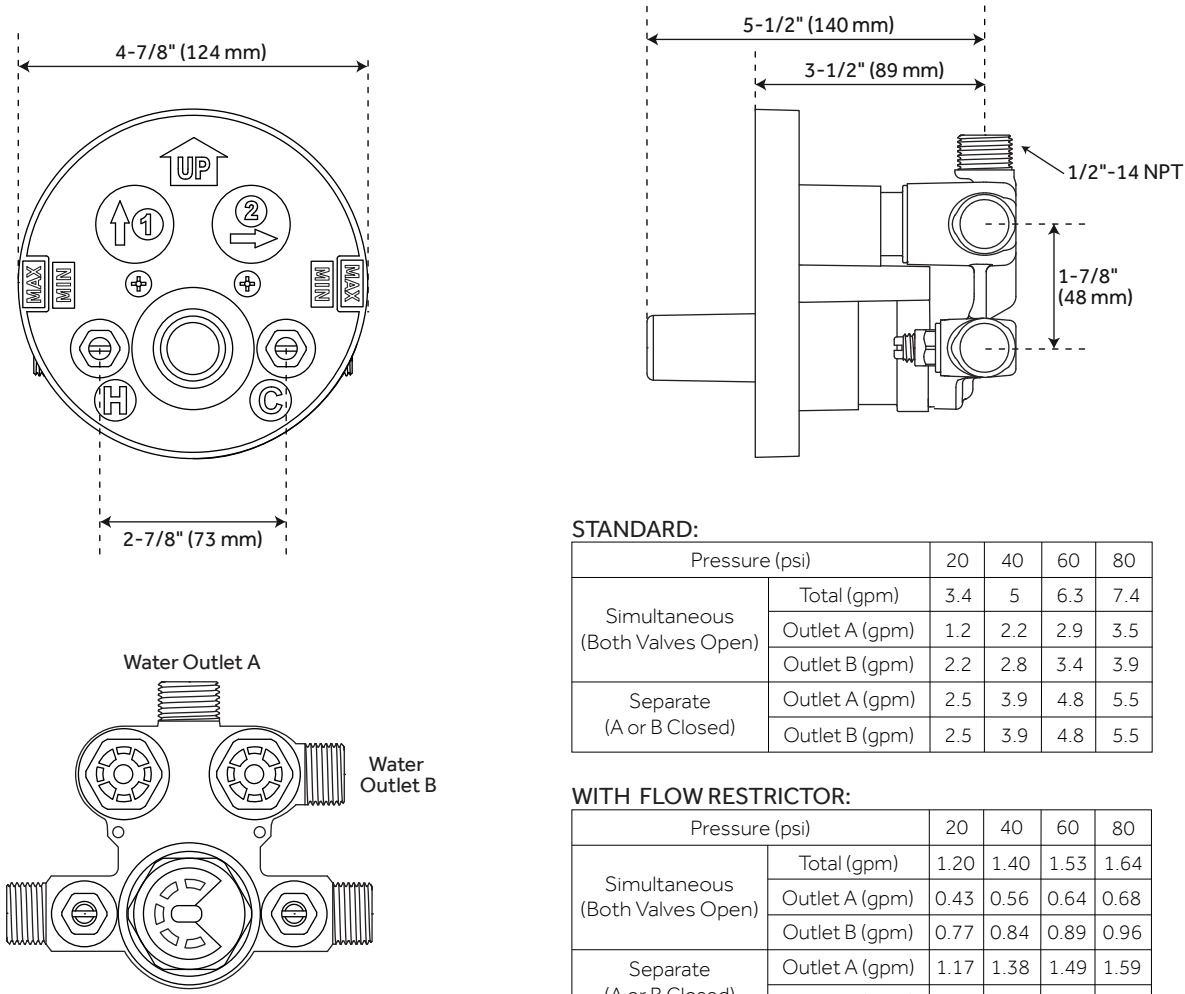

STANDARD:

Pressure (psi)		20	40	60	80
Simultaneous (Both Valves Open)	Total (gpm)	3.4	5	6.3	7.4
	Outlet A (gpm)	1.2	2.2	2.9	3.5
	Outlet B (gpm)	2.2	2.8	3.4	3.9
Separate (A or B Closed)	Outlet A (gpm)	2.5	3.9	4.8	5.5
	Outlet B (gpm)	2.5	3.9	4.8	5.5

WITH FLOW RESTRICTOR:

Pressure (psi)		20	40	60	80
Simultaneous (Both Valves Open)	Total (gpm)	1.20	1.40	1.53	1.64
	Outlet A (gpm)	0.43	0.56	0.64	0.68
	Outlet B (gpm)	0.77	0.84	0.89	0.96
Separate (A or B Closed)	Outlet A (gpm)	1.17	1.38	1.49	1.59
	Outlet B (gpm)	1.16	1.39	1.49	1.60

FEATURES

- Length: 4-7/8"
- Width: 4-3/8"
- Depth: 5-1/2"
- Connection: 1/2"-14 NPT

CODES/STANDARDS

- cUPC
- ASME A112.18.1/CSA B125.1
- ASSE 1016 Type P
- Massachusetts Accepted

PRODUCT IMAGE



All dimensions and specifications are nominal and may vary. Use actual products for accuracy in critical situations.

HIBISCUS

SQUARE RAINFALL SHOWER HEAD WITH ROUNDED CORNERS

SKU: 949740

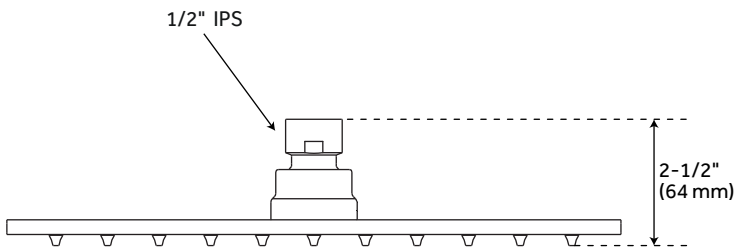
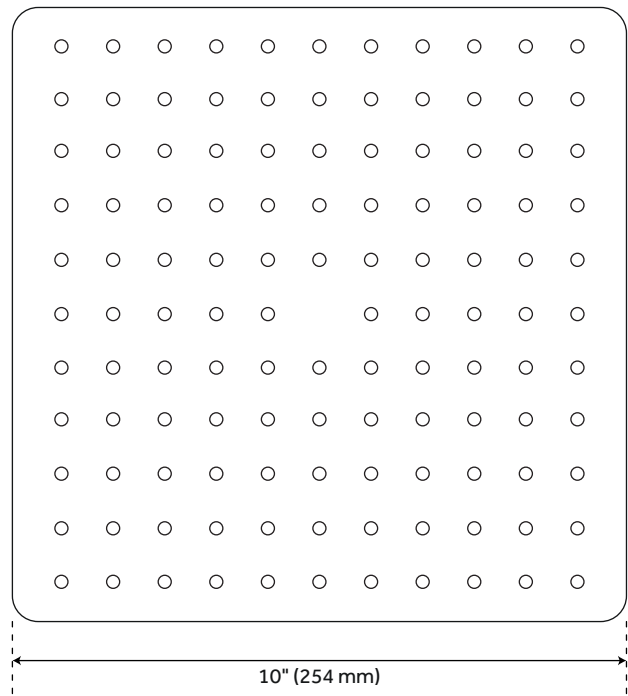

FEATURES

- Material: Stainless Steel
- Length: 10"
- Width: 10"
- Height: 2-1/2"
- Connection: 1/2" IPS
- Shower Head Flow Rate:
2.5 gpm (9.5 L/min) max @ 80 psi

CODES/STANDARDS

- cCSAus
- ASME A112.18.1/CSA B125.1
- Massachusetts Accepted

PRODUCT IMAGE



All dimensions and specifications are nominal and may vary. Use actual products for accuracy in critical situations.

HIBISCUS

CEILING-MOUNT SHOWER ARM

SKU: 949740

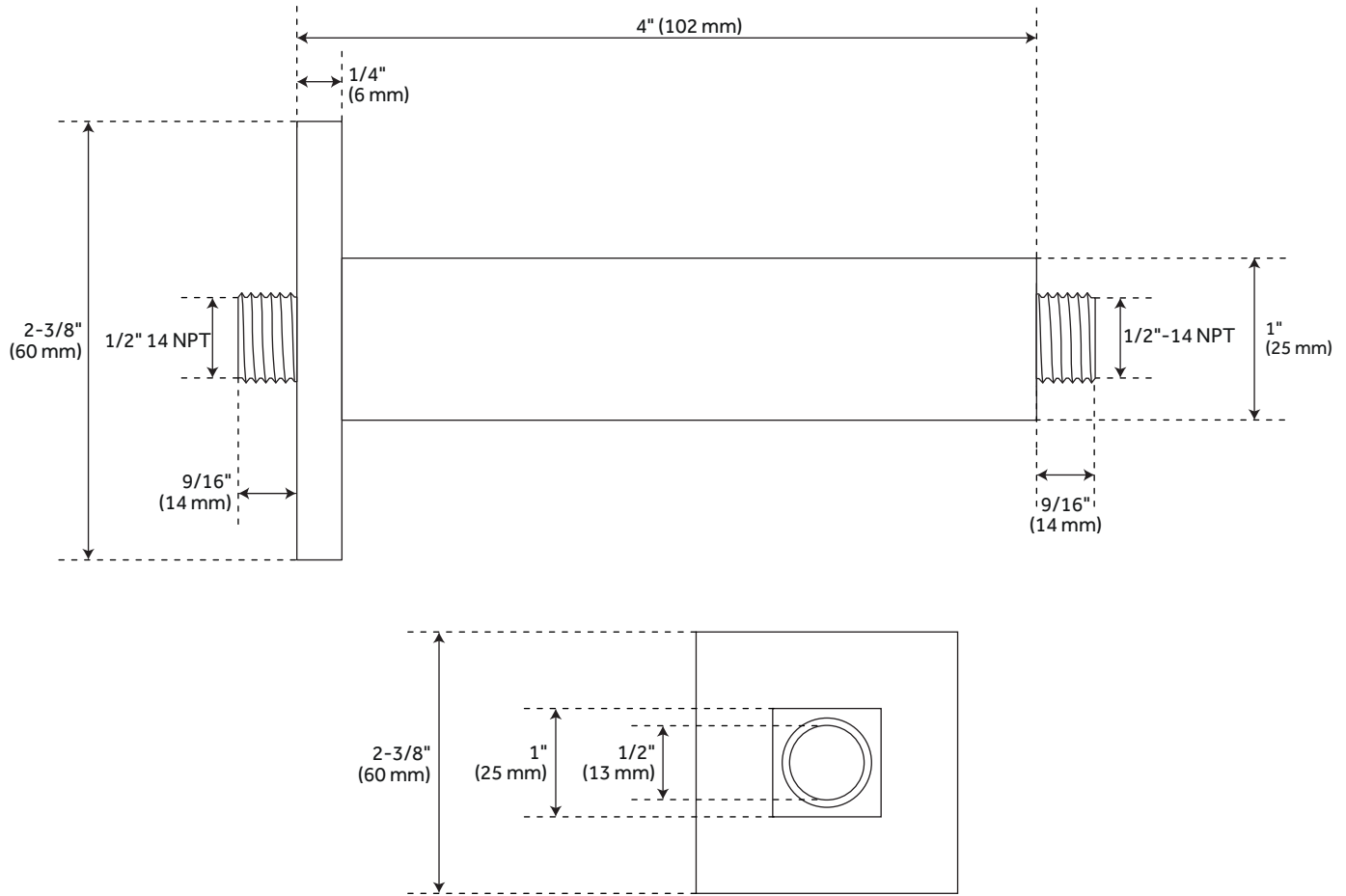

FEATURES

Material: Brass
Shower Arm Extension: 4"
Base Plate Length: 2-3/8"
Base Plate Width: 2-3/8"
Escutcheon Included
Connection: 1/2" IPS

CODES/STANDARDS

cUPC
ASME A112.18.1/CSA B125.1
Massachusetts Accepted

PRODUCT IMAGE



All dimensions and specifications are nominal and may vary. Use actual products for accuracy in critical situations.

PAGE 5
Code: SHRSC40S