

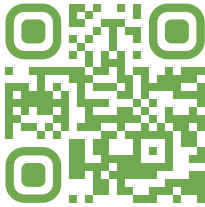

# SYMMONS® MaxLine®

## 8210CK Thermostatic Mixing Valve Specification Submittal



Model Numbers	Feature Highlights
<input type="checkbox"/> <b>8210CK</b> Thermostatic Mixing Valve	<ul style="list-style-type: none"> <li>• 3/8" compression connections</li> <li>• Integral checks</li> <li>• Stainless steel strainers for protection against suspended particles in supply lines</li> <li>• Thermal cartridge</li> <li>• Vandal resistant</li> <li>• Minimum flow rate 0.25 gpm (0.95L/min)</li> </ul> <p><b>Inlet water temperature:</b> HOT inlet range 120°F - 180°F (48.9°C - 82.2°C) COLD inlet range 39°F - 80°F (3.9°C - 26.7°C)</p> <p><b>Temperature control range:</b> 59°F - 115°F (15°C - 46°C)</p> <p><b>Minimum supply pressure:</b> 20 psi (138 kPa) <b>Maximum supply pressure:</b> 125 psi (862 kPa) <b>Inlet to outlet temperature differential:</b> 10°F (5.55°C)</p> <p>*According to US Senate bill S.3874, the term "lead free" is defined as follows: "not more than a weighted average of 0.25 percent lead when used with respect to the wetted surfaces of pipes, pipe fittings, plumbing fittings, and fixtures."</p>
Options/Modifications	
<input type="checkbox"/> <b>B</b> Wall cabinet in white enamel finish including wall mounting bracket <input type="checkbox"/> <b>D</b> 3/8" compression fitting to allow water bypass for hot and cold supply faucet <input type="checkbox"/> <b>NI</b> Rough Nickel finish <input type="checkbox"/> <b>T</b> Stainless steel cabinet in place of standard white cabinet	
<p><b>Note:</b> Append appropriate suffix to model number.</p>	<p><b>Compliance</b></p>
<p><b>Warranty</b></p> <p><b>Limited Lifetime</b> - to the original end purchaser in consumer/residential installations.  <b>10 Years</b> - for commercial/industrial installations. Refer to <a href="http://www.symmons.com/warranty">www.symmons.com/warranty</a> for complete warranty information.</p> 	<ul style="list-style-type: none"> <li>-ASME A112.18.1/CSA B125.1</li> <li>-ASSE 1017/CSA B125.3</li> <li>-ASSE 1070/CSA B125.3</li> <li>-NSF/ANSI 372</li> <li>-NSF/ANSI/CAN 61: Q&lt;1</li> <li>-CSA B125.3</li> </ul> 

### Architectural/Engineering Specification

Symmons MaxLine \_\_\_\_\_ TMV, 2.06GPM@10PSI, minimum thermostatically controlled flow rate 0.25GPM. Solid brass body, integral spring checks, stainless steel debris strainer, 3/8" compression ports. Temperature control range of 59F-115F degrees. Vandal-resistant cap. Mounting bracket included. 10-Year Commercial Warranty. 1070/1017 and A112.18.1 certified. Available options: "B - Wall cabinet white", "D - Cold water bypass", "NI - Rough Nickel Finish" and "T - Stainless Steel cabinet."

## Flowrates

**Table 1: Flow Rate - gpm (L/min)**

Valve Model	Size Connection	Min. Flow Rate	Pressure Differential - psi (kPa)					
			5 psi (34 kPa)	10 psi (69 kPa)	20 psi (138 kPa)	25 psi (172 kPa)	30 psi (207 kPa)	45 psi (310 kPa)
8210CK	3/8" (10 mm)	0.25 gpm (0.95 L/min)	1.32 gpm (5.0 L/min)	2.06 gpm (7.8 L/min)	2.74 gpm (10.4 L/min)	3.11 gpm (11.8 L/min)	3.38 gpm (12.8 L/min)	4.22 gpm (16.0 L/min)

## Dimensions

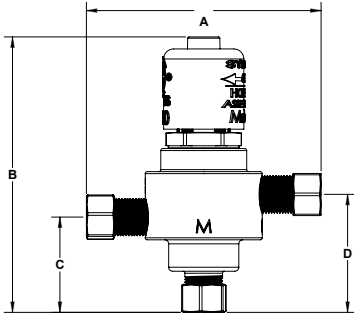

Wall cabinet (optional)

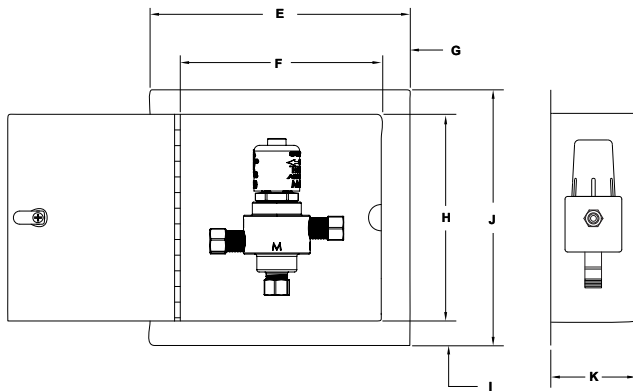

**Measurements 8210CK**

<b>A</b>	3-1/2", 89 mm
<b>B</b>	4-1/8", 104 mm
<b>C</b>	1-7/16", 37 mm
<b>D</b>	1-3/4", 45 mm
<b>E</b>	12-1/4", 311 mm
<b>F</b>	10", 254 mm
<b>G</b>	1-1/8", 29 mm
<b>H</b>	10", 254 mm
<b>I</b>	1-1/8", 29 mm
<b>J</b>	12-1/4", 311 mm
<b>K</b>	4", 102 mm

**Note:** Dimensions are subject to change without notice.

## Parts Breakdown

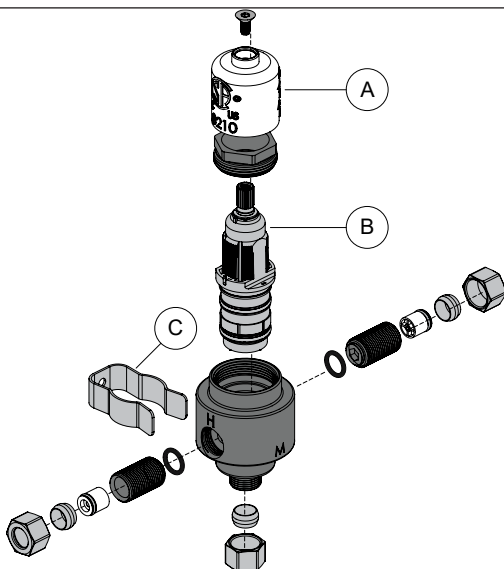

**Replacement Parts 8210CK\*\*\*\*\***

Item	Description	Part No.
<b>A</b>	Safety cap	TMX302
<b>B</b>	Cartridge	TMX303
<b>C</b>	Wall Mount Hanger Bracket	TMX304