

# INSTRUCTIONS FOR HANDLE FITS MOEN® TUB/SHOWER

English

**Note:** Your faucet may not match illustration.

1. Turn water off to faucet.
2. Remove original handle (A) using hex wrench (B) (not included).
3. Remove original handle adapter (C), this is not needed for replacement.
4. Using screwdriver, screw (D) of new handle into cartridge.
5. Place decorative cap (E) over exposed screw on handle.
6. Turn on water to faucet, check for leaks.

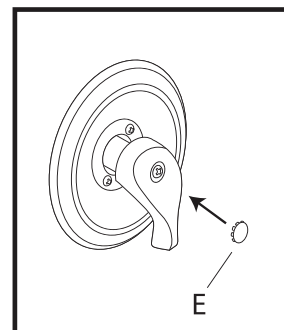
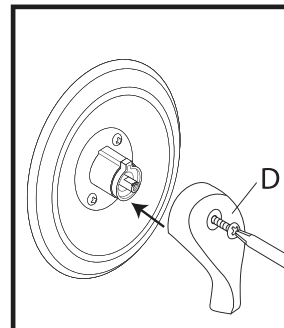
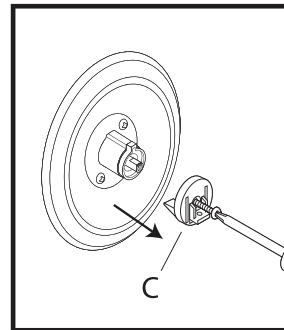
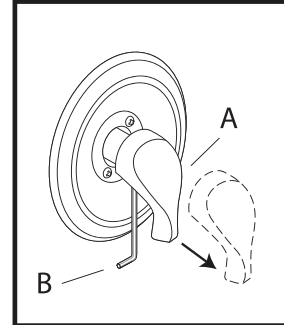

# INSTRUCCIONES PARA EL AJUSTE DEL MANGO MOEN® PARA BAÑERAS/ DUCHAS

Español

**Nota:** Es posible que su grifo no coincida con la ilustración.

1. Cierre el agua del grifo.
2. Retire la manija original (A) con una llave hexagonal (B) (no se incluye).

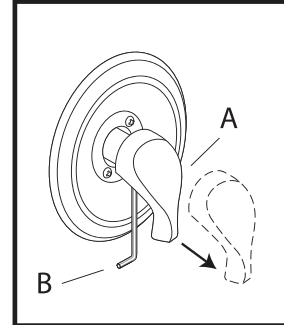

3. Retire el adaptador de manija original (C) ya que este no es necesario para el reemplazo.

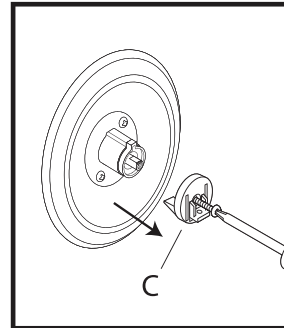

4. Con un destornillador, atornille (D) la manija nueva en el cartucho.

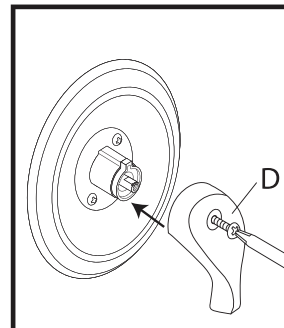

5. Coloque la tapa decorativa (E) sobre el tornillo expuesto de la manija.
6. Abra el grifo del agua y verifique que no haya fugas.

