

F1960 BRASS PEX FEMALE SWEAT ADAPTER

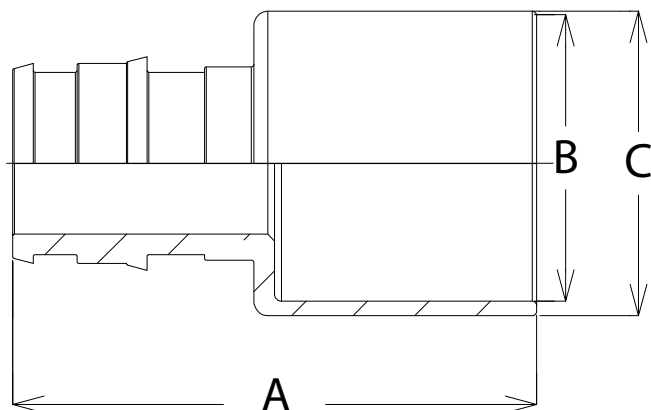

- Simple and dependable plumbing connection
- Easy installation
- Leak-proof connections
- Lead-free DZR brass
- Can be used with F1960 PEX rings
- Tested and certified to ASTM F1960
- Certified to NSF/ ANSI/ CAN 61- 2019, NSF/ ANSI 372-2016, and NSF/ ANSI 14-2015
- Certified to CSA B137.5-2020
- cUPC listed



Part No.	Description	A - in (mm)	B - in (mm)	C - in (mm)	Weight-lbs (grams)
F76845B	3/4" F1960 x 1/2"	1.51 (38.30)	0.63 (15.98)	0.71 (18.10)	0.07 (32.66)
F76844B	3/4" F1960 x 1"	1.91 (48.55)	1.13 (28.70)	1.22 (30.90)	0.11 (49.90)
F76846B	3/4" F1960	1.74 (44.15)	0.88 (22.33)	0.96 (24.40)	0.08 (36.29)
F76843B	1/2" F1960 x 3/4"	1.50 (38.15)	0.88 (22.33)	0.96 (24.40)	0.06 (27.22)
F76842B	1/2" F1960	1.24 (31.50)	0.63 (15.98)	0.71 (18.10)	0.04 (18.14)
F76841B	1" F1960	2.15 (54.55)	1.13 (28.70)	1.22 (30.90)	0.15 (68.04)

F1960 Specified Dimensions	ID - in (mm)	OD - in (mm)
1/2" End Connection	.41 (10.33)	.61 (15.59)
5/8" End Connection	.53 (13.40)	.74 (18.90)
3/4" End Connection	.62 (15.80)	.87 (22.10)
1" End Connection	.83 (21.00)	1.11 (28.10)