

Specifications

PFTPB100 / 200 SERIES FLANGED/DOUBLE FLANGED TAILPIECE



Product Features

- Diameter: 1-1/2" OD
- Constructed from brass
- End Connection Type: Flanged / Double Flanged
- Used with kitchen, laundry, or bathroom sinks and More For use as a drain piping tailpiece
- Meets ASME A112.18.2
- cUPC/IAPMO listed



PFTPB100

PFTPB200

✓ For Submittal	Model Number	Description	Dimensions		Gauge B	Finish	cUPC
			A				
			in	mm			
	PFTPB100	1-1/2X4 FLANGED TAILPIECE	4	101.6	17	Chrome	Y
	PFTPB101	1-1/2X6 FLANGED TAILPIECE	6	152.4	17	Chrome	Y
	PFTPB102	1-1/2X8 FLANGED TAILPIECE	8	203.2	17	Chrome	Y
	PFTPB103	1-1/2X12 FLANGED TAILPIECE	12	304.8	17	Chrome	Y
	PFTPB104	1-1/2X12 FLANGED TAILPIECE	12	304.8	20	Unfinished	Y
	PFTPB105	1-1/2X4 FLANGED TAILPIECE	4	101.6	20	Unfinished	Y
	PFTPB106	1-1/2X6 FLANGED TAILPIECE	6	152.4	20	Unfinished	Y
	PFTPB107	1-1/2X8 FLANGED TAILPIECE	8	203.2	20	Unfinished	Y
	PFTPB108	1-1/2X4 FLANGED TAILPIECE	4	101.6	20	Chrome	Y
	PFTPB109	1-1/2X6 FLANGED TAILPIECE	6	152.4	20	Chrome	Y
	PFTPB110	1-1/2X8 FLANGED TAILPIECE	8	203.2	20	Chrome	Y
	PFTPB111	1-1/2X12 FLANGED TAILPIECE	12	304.8	20	Chrome	Y
	PFTPB112	1-1/2X12 FLANGED TAILPIECE	12	304.8	22	Chrome	N
	PFTPB113	1-1/2X6 FLANGED TAILPIECE	6	152.4	22	Chrome	N
	PFTPB114	1-1/2X8 FLANGED TAILPIECE	8	203.2	22	Chrome	N
	PFTPB116	1-1/2X12 22 GA RB FLG SINK TLPC	12	304.8	22	Unfinished	N
	PFTPB118	1-1/2X24 22 GA FLG SINK TLPC RB	24	609.6	22	Unfinished	N
	PFTPB200	1-1/2X16 DOUBLE FLANGED TAILPIECE	16	406.4	20	Chrome	Y
	PFTPB201	1-1/2X16 DOUBLE FLANGED TAILPIECE	16	406.4	20	Unfinished	Y
	PFTPB202	1-1/2X16 DOUBLE FLANGED TAILPIECE	16	406.4	22	Chrome	N

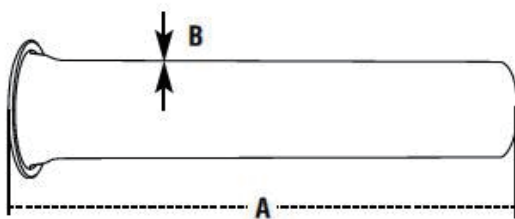

PFTPB100 SERIES

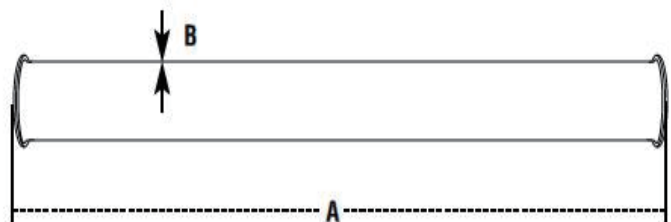

PFTPB200 SERIES

* All measurements are nominal. Please verify before actual installation.

Warranty and Codes

This PROFLO product carries a 1-year limited warranty. This product meets ASME: A112.18.2.

