

VAR	MODEL	CUSTOMER	CATALOG	A	HP	VOLTS	SF	SF AMPS	HZ	RPM	50 HZ VOLTS	50 HZ AMPS	BEARINGS	ROTATION	FACTORY WIRED FOR	BASE REQUIREMENT	HIGH EFFICIENCY LABEL REQUIREMENT
001	P63TLH-4853	COMMERCIAL PUMPS	EE607	12.37	1-1/2	208-230/460	1.3/1.0	6.0-5.8/2.9	60/50	3450/2850	190/380-415	5.2/2.6-2.7	BALL	CCW SHAFT END	LOW VOLTAGE	NO	NO
002	P63TLJ-4854	COMMERCIAL PUMPS	EE733	12.87	2	208-230/460	1.25/1.0	6.8-6.4/3.2	60/50	3450/2850	190/380-415	6.4/3.2-3.1	BALL	CCW SHAFT END	LOW VOLTAGE	NO	NO
003	P63TLK-4855	COMMERCIAL PUMPS	EE734	13.87	3.0	208-230/460	1.15/1.0	9.6-9.4/4.7	60/50	3450/2850	190/380-415	9.8/4.9-4.8	BALL	CCW SHAFT END	LOW VOLTAGE	NO	NO
004	P63TLJ-4879	COMMERCIAL PUMPS	EE607B	12.37	1-1/2	208-230/460	1.3/1.0	6.0-5.8/2.9	60/50	3450/2850	190/380-415	5.2/2.6-2.7	BALL	CCW SHAFT END	LOW VOLTAGE	STD N56	YES
005	P63TLK-4880	COMMERCIAL PUMPS	EE733B	12.87	2	208-230/460	1.25/1.0	6.8-6.4/3.2	60/50	3450/2850	190/380-415	6.4/3.2-3.1	BALL	CCW SHAFT END	LOW VOLTAGE	STD N56	YES
006	P63TLL-4881	COMMERCIAL PUMPS	EE734B	13.87	3.0	208-230/460	1.15/1.0	9.6-9.4/4.7	60/50	3450/2850	190/380-415	9.8/4.9-4.8	BALL	CCW SHAFT END	LOW VOLTAGE	N56H	YES

REV: 1

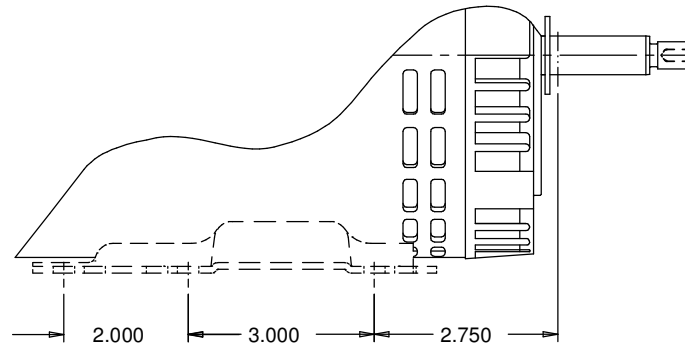

PARTIAL VIEW
SHOWING N56H BASE

SHEET NUMBER	REV	REVISION RECORD FOR: E23065		
2 OF 2	1	OBSOLETE VAR.006		
REVISION DATE				
01-JUL-15				
ISSUED BY	REVIEWED BY	ENGINEER APPROVED		
C.ALMAQUER	K.GENTSCH	V. RIVERA		

INFORMATION DISCLOSED ON THIS DOCUMENT IS CONSIDERED PROPRIETARY AND SHALL NOT BE REPRODUCED OR DISCLOSED WITHOUT WRITTEN CONSENT OF NIDEC MOTOR CORPORATION

NIDEC MOTOR CORPORATION

ALL DIMENSIONS ARE FOR REFERENCE ONLY UNLESS TOLERANCE IS GIVEN

TITLE
ASSEMBLED VIEW

CODE
V01

ITEM NO.
782426

SIZE
B