

1-1/2" ANGLE HOSE VALVE

Figure 1201



NFP120109

INSTALLATION

Use an approved thread sealant on the threads that the hose valve will be installed on. **DO NOT OVER TIGHTEN.** Over-tightening may cause cracks or deformities in the valve body which could lead to failure.

FEATURES & BENEFITS

- Size: 1-1/2" NPT
- Connection Type: Thread
- Body Material: Brass
- Finish: Rough brass
- Hand Wheel: Red aluminum
- Max Pressure: 300 psi

TECHNICAL DATA

- Max Temperature: 250°F
- Max Pressure: 300 psi



*Not for use in potable systems

1-1/2" ANGLE HOSE VALVE

Figure 1201

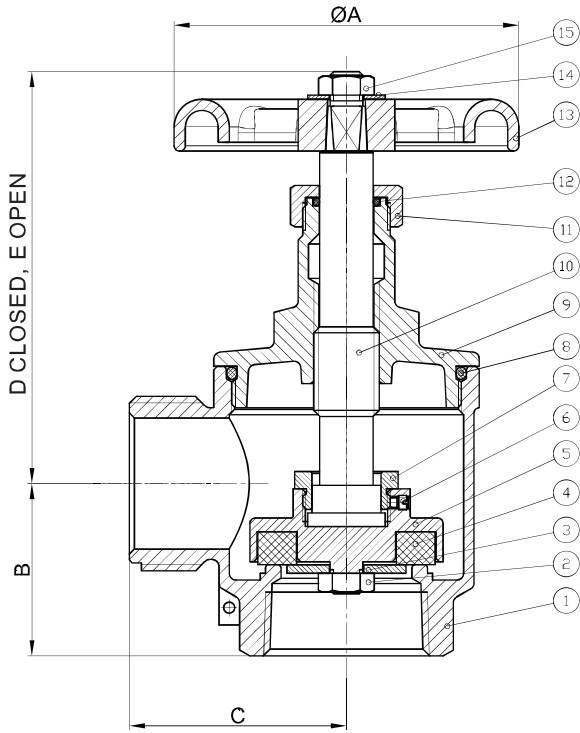

MATERIAL CHART

NO.	PART NAME	MATERIAL
1	Body	Brass ASTM B283 C37700
2	Nut	Brass ASTM B283 C37700
3	Washer	304 SS
4	Seat Seal	EPDM
5	Holder	Brass ASTM B283 C37700
6	Set Screw	304 SS
7	Lock Nut	Brass ASTM B283 C37700
8	O-Ring	EPDM
9	Bonnet	Brass ASTM B283 C37700
10	Stem	Brass ASTM B283 C37700
11	Lock Nut	Brass ASTM B283 C37700
12	O-Ring	EPDM
13	Hand Wheel	ZL 102 Aluminum
14	Wheel Washer	304 SS
15	Wheel Nut	Brass ASTM B283 C37700

DIMENSION (INCHES)

PART #	SIZE	THREADS	A	B	C	D	E
NFP120108	1-1/2"	FNPT X MNST	3.94	1.97	2.48	4.69	5.71
NFP120109	1-1/2"	FNPT X FNPT	3.94	1.97	2.60	4.69	5.71