

PURELL® CXM™, CXI™ and CXT™ REFILL LOADING INSTRUCTIONS

These instructions apply to PURELL brand CXM, CXI and CXT dispensers.

Please read all instructions carefully before loading the refill.

Refill Installation

(refill © sold separately)

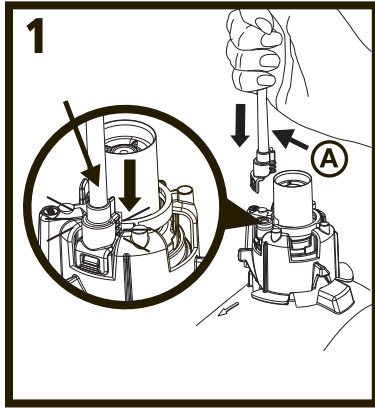

Insert dispenser straw (A).

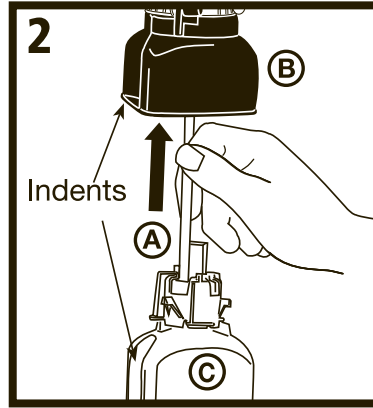

Feed the dispenser straw (A) on the refill bottle (C) up through the motor assembly/bottle support (B) and dispenser assembly, aligning the two indents in the bottle and the support. Slide the refill bottle upward until it snaps into place.

NOTE: The refill is not properly installed until you hear the "snap" (as the green release latch on the motor assembly/bottle support (B) engages).

Refill Removal

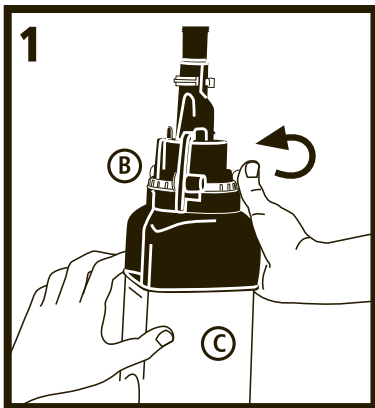

Grasp the empty refill bottle (C) with one hand and use the other hand to push the green release latch on the motor assembly/bottle support (B) to the right (counterclockwise as seen from above).

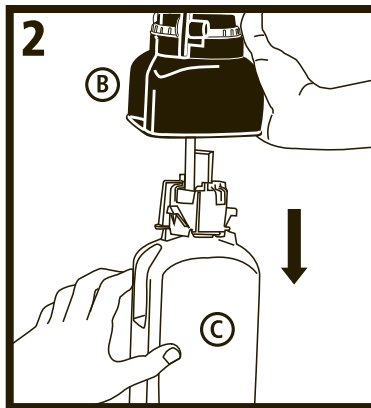

While still pushing the green release latch, pull downward on the refill bottle (C) and remove it from the motor assembly/bottle support (B).



GOJO Industries, Inc.
One GOJO Plaza, Suite 500
P.O. Box 991 • Akron, OH 44309-0991
Tel: 1-330-255-6000 • Toll-free: 1-800-321-9647
Fax: 1-800-FAX-GOJO