



# LANCASTER WATER TREATMENT

## Clear-Flo HALO SHIELD

PROTECT YOUR INVESTMENT WHILE PROTECTING YOUR FAMILY.

### FEATURES

- Optional gauge and drain ports
- Suitable for 4.5" x 10" cartridges
- NPT connection ports 1"
- Reversible Mounting Bracket
- Pressure-relief feature includes an O-ring seal, no spring is used that can result in a water leak
- Designed to the highest standard in the industry
- More effective than chemicals in destroying certain waterborne contaminants without altering the taste of water
- Environmentally responsible way of treating your water
- Includes blue O-ring to avoid confusion with competitors black O-rings
- Accessories included: housing wrench, and LubriKit for O-ring lubrication

### BACTERIA REDUCTION WITH SEDIMENT PRE-FILTRATION

Our Clear-Flo Halo Shield safeguards your family with a high-intensity ultraviolet lamp and core chamber technology. The cartridge filter preserves the UV, filtering sediment for crystal-clear water.

The ultraviolet purifier takes a page from the technology of nature, as the UV rays penetrate bacteria, disinfecting your water while sterilizing 99.99% of harmful microorganisms. This neutralizes harmful bacteria that can create waterborne illness within your home. Unlike chlorine, UV does not alter the taste or odor of water and will not impart any toxic by-products. Treating your water supply with UV disinfection is not only more effective than traditional treatments, but it is also environmentally responsible.

The cartridge filter utilizes a BIG housing specifically designed for cartridges with an outer diameter of 4.5" and a pressure rating of 120 PSI adaptable to any large capacity filtration or heavy-duty application. The 4.50" OD melt-blown polypropylene cartridge is suitable to many applications due to its wide chemical-physical compatibility to a variety of water-based solutions.

Experience the peace of mind that comes with this integrated unit.

NOTE: Pretreatment for hardness and iron may be required.



# Clear-Flo HALO SHIELD

EXCELLENT FOR BOTH MUNICIPAL AND WELL WATER APPLICATIONS.

Model No.	Description
<b>Optional Accessories</b>	
410-DRKT	Bottom Drain Kit
410-GAUGE	1/8" NPT Pressure Gauge (two needed for accurate readings)



Bottom Drain Kit



NPT Pressure Gauge

Model No.	Description
<b>Replacement Parts</b>	
410-C5-MB	5 Micron Sediment Cartridge
7-L6	9 GPM UV Lamp (11-13/16")
7-Q6	Domed Quartz Sleeve (13-1/8")
7-UVC	Electronic Ballast

### EXAMPLE OF A TYPICAL INSTALLATION

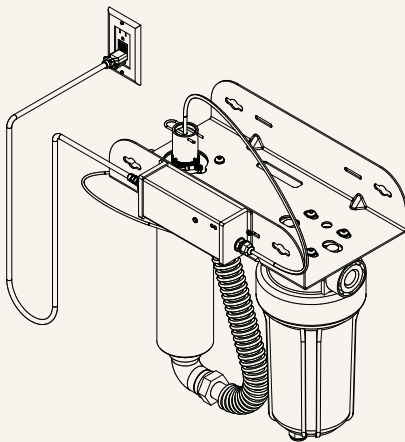

Model No.	7-LWT-UV410-009
Fluence (UV Dose) @ 95% UVT and EOL	Flow Rate
US Public Health (16 mJ/cm <sup>2</sup> )	17 GPM
Industry Standard (30 mJ/cm <sup>2</sup> )	9 GPM
NSF/EPA (40 mJ/cm <sup>2</sup> )	7 GPM
<b>Electrical</b>	
Voltage	110V to 240V AC 50/60Hz *
Power Consumption	34 W
Lamp Watts	29 W
Max/Min Operating Pressure	120 PSI/7.25 PSI
Ambient Air & Water Temperature	36 to 104° F
<b>Dimensions</b>	
Overall	21" x 20.44" x 11.25" **
Controller	8" x 3" x 2.25"
Inlet/Outlet Port Size	1.0" FNPT Filter Housing Head Inlet/ 1.0" MNPT UV Chamber Outlet
Shipping Weight	24.5 lbs.
<b>Features</b>	
Filter Cartridge Type	5 Micron Nominal, 4.50" OD x 10" Nominal Height, PP Melt-Blown with DOE
Filter Housing Material	10" Reinforced PP Head and Blue Bowl, PP Vent Valve Body, EPDM O-Rings
UV Chamber Material	304 SS
Lamp-On Indicator	Steady "Work" Green LED
Lamp Life Remaining (Days)	Visual Count Down Display (365-0); Manual Reset Function
Lamp Replacement Reminder	Visual Display (A3), "Fault" Red LED Flashes and Audible Alarm Sounds Intermittently (1 sec. Beep every 5 sec.)
Lamp Failure Indicator	Lamp Life Remaining (days) continues to be displayed but stops counting down, "Fault" Red LED flashes and audible alarm sounds intermittently (1 sec. beep every 1 sec.)
Ballast Total Running Days	Visual Incremental Display (0-9999); Cannot Be Reset
Ballast Failure Indicator	Blank Display

\*Supplied with cord set for 120VAC 60Hz  
 \*\* Mounting holes 16" on center