

# Faucet Installation Instructions

MNO500D

- Hole diameters are 1 1/4" minimum to 2 1/2" maximum
- Maximum deck thickness is 2 3/8" (single hole/faucet only mounting) or 2 1/4" (with escutcheon)
- This kitchen faucet comes completely assembled and water tested
- Includes supply lines with 1/2" IPS Inlets
- Tools required-channel lock pliers (or pipe wrench), basin wrench and small crescent wrench
- Shut off water supply prior to beginning installation

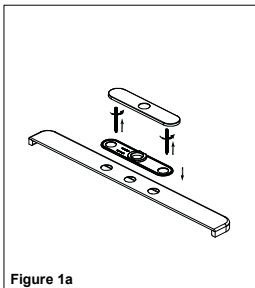

Figure 1a

### Step 1a Three Hole Mounting

Screw bolts to the escutcheon. Insert escutcheon assembly through the base plate and the holes of the sink.

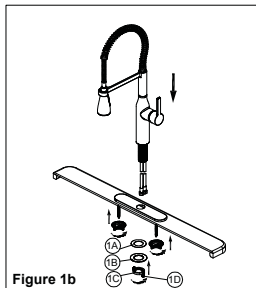

Figure 1b

### Step 1b Three Hole Mounting

Insert faucet through hole in escutcheon. From underneath sink, attach rubber washer (1A), metal washer (1B), and nut (1C). Lock nut (1C) into position by tightening screws (1D).

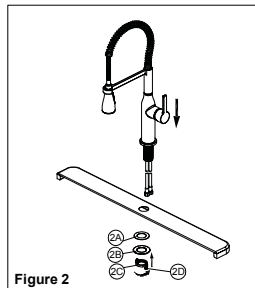

Figure 2

### Step 2 Single Hole Mounting

Insert faucet through hole in sink or countertop. From underneath sink, attach rubber washer (2A), metal washer (2B), and nut (2C). Lock nut (2C) into position by tightening screws (2D).

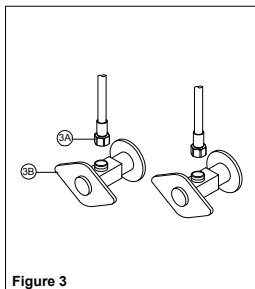

Figure 3

### Step 3

Making the waterline connections  
Thread the nut (3A) on supply line onto outlet of water supply valve (3B) and tighten with wrench. Do not overtighten.

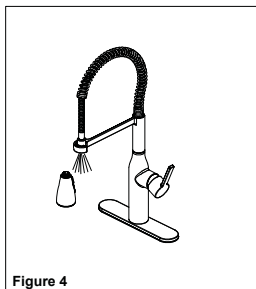

Figure 4

### Step 4

**Important:** After installation is completed, to prevent damage to the internal parts of your faucet from debris that may have collected in the water lines, it will be necessary to flush the faucet. Turn on hot/cold water supplies and remove spray head. Hold the end of the hose down into the sink and turn the faucet on to the warm position so hot and cold water are mixed. Flush water lines for one minute. Check for leaks and re-tighten any connections if necessary. Reinstall spray head by screwing onto end of hose by hand.

MISENO

For additional assistance or service call: 1-855-480-2915 or visit our website [www.miseno.com](http://www.miseno.com)

# Faucet Installation Instructions

MNO500D

**NOTE:** This faucet is equipped with a two function sprayer plus a Pause function. Once the faucet turned off it will automatically revert back to regular aerated stream.

**Button A:** Changes flow from regular stream to full spray.

**Button B:** Changes flow from full spray to regular stream.

**PAUSE:** To initiate Pause please press & hold Button B. Release when you wish to have water flow begin again.

| Finish Codes | *Specify Finish     |
|--------------|---------------------|
| CP           | Polish Chrome       |
| SS           | Stainless Steel PVD |

**Parts**

**Maintenance:** Clean with warm water, soft cotton cloth and non-abrasive liquid dish soap. Towel dry. Never use acids, harsh abrasives, detergents, or products containing chlorides on any parts of this product.

MISENO

For additional assistance or service call: 1-855-480-2915 or visit our website [www.miseno.com](http://www.miseno.com)