

## Specifications

# PFXC900

# TWO-HANDLE WALL MOUNT UTILITY FAUCET



### Product Features

- 1/2" IPS inlets
- Adjustable centers from 7" to 9"
- 6" cast brass spout
- 1.8 GPM Water saving aerator
- Meets ANSI: A112.18.1M
- NSF-61 compliant
- UPC/IAPMO listed
- Renewable seats and stems
- Polished chrome finish



**PFXC900**

### Product Specifications

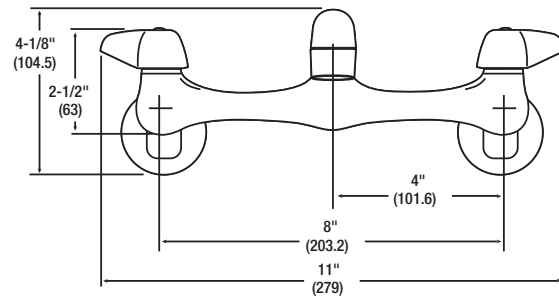
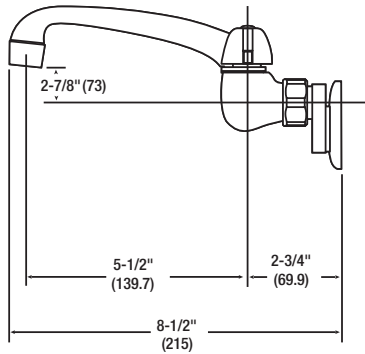

NOTE: All dimensions and specifications are nominal and may vary  $\pm 1/4"$ . Use actual products for accuracy in critical situations.

### Warranty and Codes

This product comes complete with installation, operating, care and maintenance instructions. This PROFLO faucet carries a limited lifetime warranty when installed in residential applications. The warranty is five years in commercial applications. This product meets ASME: A112.18.1.

\*Compliant with lead content requirements of US Senate Bill S.3874.

©2022 Ferguson Enterprises, LLC. FG 09/2022



[FERGUSON.COM/PROFLO](http://FERGUSON.COM/PROFLO)