

Top Lit Tri-view MEDICINE CABINET

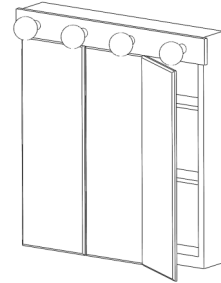

FEATURES/TYPICAL SPECIFICATIONS

- Surface Mount Installation
 - Pre-drilled mounting holes
- Formed and welded steel housing (WB/ST)
 - 20 gauge steel construction with white, heat cured, acrylic paint finish
- Frameless mirror doors
 - 3/16" thick float glass mirror door front with 1/2" beveled edges, around perimeter of 3 assembled mirrors.
 - 24 gauge steel, pan formed, door back with white, heat cured, acrylic paint finish
- 90° concealed, euro-type hinge, adjustable and self-closing with plastic and metal components (6 typical / 2 per door)
- 26 gauge galvanized steel shelves with white, heat cured, enamel paint finish (2 typical)
 - Fixed shelves — removable (FX2)
- Built-in top light fixture with a chrome plated 24 gauge steel faceplate and polished chrome socket cups (typical 3-6). (Uses four incandescent 60 watt maximum, G style, 120V bulbs (I60G) - bulbs not included)
- Includes installation hardware

Finishes:

Housing: PT01—Basic White
 Mirror: 1/2 BVL—1/2" Bevel Edge
 Frame: Frameless

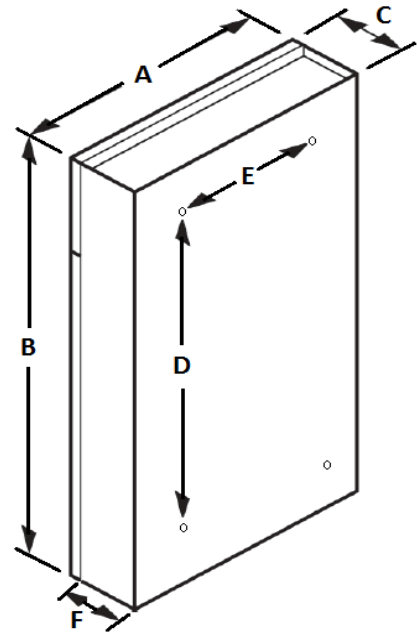

Model #	Description	Dimensions In Inches					
		A	B	C	D	E	F
255224LGT	MEDCAB 3DR 24X31 FMLS BV WB/ST	24	30.813	5.904	23.5	15.25	4.375
255230LGT	MEDCAB 3DR 30X31 FMLS BV WB/ST	30	30.813	5.904	23.5	21.25	4.375
255236LGT	MEDCAB 3DR 36X31 FMLS BV WB/ST	36	30.813	5.904	23.5	27.25	4.375
255248LGT	MEDCAB 3DR 48X31 FMLS BV WB/ST	48	30.813	5.904	23.5	39.25	4.375

The "C" dimension is cabinet only without socket cups and bulbs.

REFERENCE	QTY.	REMARKS	Project
			Location
			Architect
			Engineer
			Contractor
			Submitted by Date

* All models and material specifications are subject to change or withdrawal without notice.